

**SPECIFICATIONS:**

POWER RATING: 5 WATTS AT 40°C.  
6 WATTS AT 25°C.

FREQUENCY RANGE & VSWR:

DC TO 1GHz AT 1.10:1 MAX.  
1GHz TO 4GHz AT 1.25:1 MAX.

AMBIENT TEMPERATURE RANGE: -40°C TO +40°C  
CONNECTOR OPTIONS: DEPENDS ON CONNECTOR KIT

OPERATING POSITION: ANY  
COOLANT: DRY (CONVECTION COOLED)

DIMENSIONS: 1.60" L X .79" DIA.

WEIGHT: 6.2 O.Z.

- DIM'S. AND WEIGHT ARE WITHOUT ADAPTERS

REVISIONS		DWG. NO.	5-A-FFI-XX	SHEET	REV
ZONE	REV	DESCRIPTION	DATE	APPROVED	
	A	CONVERT TO BEC FORMAT	DMR 6-16-03	<i>MRV</i>	

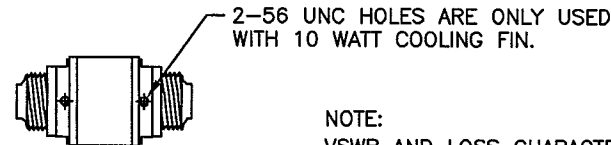
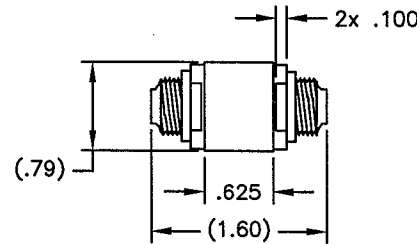
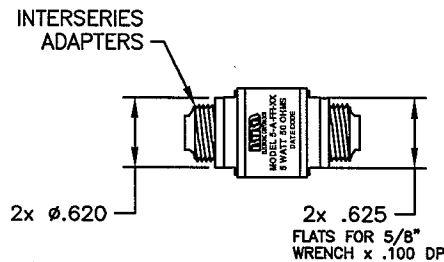

NOTE:  
VSWR AND LOSS CHARACTERISTICS OF THE COMPLETE ATTENUATOR/ADAPTER ASSEMBLY MAY BE DERATED BY INTERSERIES OR CUSTOMER-SUPPLIED ADAPTERS.

**NOTE:**

FOR VALUES NOT LISTED, REFER TO THE NEXT HIGHER ATTENUATION LEVEL FOR SPECIFICATIONS. FOR ATTENUATION VALUES GREATER THAN THE HIGHEST LISTED ATTENUATION VALUE, REFER TO THE VALUE 1/2 THE DESIRED ATTENUATION LEVEL, THEN DOUBLE THE LISTED SPECIFICATION VALUES, UNLESS OTHERWISE SPECIFIED.

XX = DASH NUMBER (dB VALUE)

-30	30	±0.8 dB	±1.3 dB
-20	20	±0.5 dB	±1.0 dB
-10	10	±0.4 dB	±0.8 dB
-06	6	±0.4 dB	±0.6 dB
-03	3	±0.3 dB	±0.5 dB
-02	2	±0.3 dB	±0.5 dB
-01	1	±0.3 dB	±0.5 dB

DASH NO.	dB ATTEN.	DC - 1GHz	1 - 4GHz
		ATTENUATOR	ACCURACY ±dB

UNLESS OTHERWISE SPECIFIED DIMENSIONS ARE IN INCHES TOLERANCES ARE:

FRACTIONS DECIMALS ANGLES  
± 1/64 .XX= ±.010 ± 30'  
.XXX= ±.005

MILLIMETERS  
.X= ±.4  
.XX= ±.12

DO NOT SCALE DRAWING

THIS DRAWING IS THE PROPERTY OF THE BIRD ELECTRONIC CORPORATION. THE DESIGNS AND SPECIFICATIONS DISCLOSED HEREON ARE PROPRIETARY AND SHALL NOT BE REPRODUCED, NOR COPIED, NOR USED AS THE BASIS FOR THE MANUFACTURE OR SALE OF APPARATUS OR DEVICES WITHOUT THEIR EXPRESS WRITTEN CONSENT.



MATERIAL

APPROVALS	DATE	TITLE
DRAWN D.M.RINK	6-16-03	ATTENUATOR, CONVECTION COOLED W/ADAPTABLE CONNECTORS, 5W
CHECKED		
APPROVED <i>MRV</i>	6-24-03	
	AUTOCAD	

SIZE	FSCM NO.	DWG. NO.	REV
A	70998	5-A-FFI-XX	A
SCALE	COMM CODE	SHEET	
1:1	AT1	1 OF 1	